

PROPRIETARY

THE INFORMATION CONTAINED IN OR DISCLOSED BY THIS DOCUMENT IS CONSIDERED PROPRIETARY BY STRATEDGE CORPORATION. THE ITEMS AND INFORMATION CONTAINED OR DISCLOSED HEREIN SHALL NOT BE USED, COPIED OR REPRODUCED IN WHOLE OR IN PART, NOR SHALL THE CONTENTS BE REVEALED IN ANY MANNER TO ANY PERSON UNLESS WRITTEN PERMISSION IS FIRST OBTAINED FROM STRATEDGE CORPORATION.

NOTES, UNLESS OTHERWISE SPECIFIED:

- 1 MATERIAL: BASE SHALL BE MATCHED EXPANSION, HIGH THERMAL CONDUCTIVITY METAL. CERAMIC SHALL BE 92% Al_2O_3 MINIMUM. LEAD FRAME SHALL BE KOVAR.
2. LEAD, BASE, AND CERAMIC GOLD PLATING THICKNESS SHALL BE 50 MICRONS MINIMUM, MEASURED ON MAJOR FLATS.
3. LEAD, BASE, AND CERAMIC NICKEL UNDERPLATE SHALL BE 100 TO 350 MICRONS, MEASURED ON MAJOR FLATS.
4. LID: REFERENCE STRATEDGE PART NUMBER 200076.
- 5 UN-PLATED SURFACES ARE ACCEPTABLE IN THE FOLLOWING AREAS: LEAD TIPS AND BASE RADII.
- 6 BOTTOM OF BASE AND BOTTOM OF 10 LEADS TO BE COPLANER WITHIN .005.

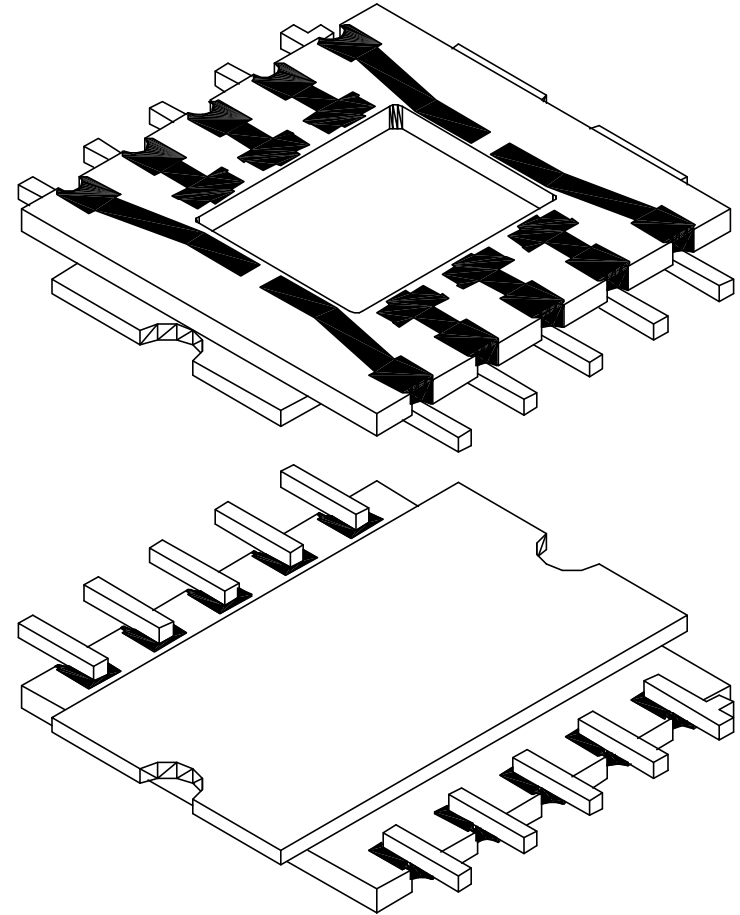

UNLESS OTHERWISE SPECIFIED ● DIMENSIONS ARE IN INCHES [MM] ● TOLERANCES: ANGLES +/- 1 DEG 4 PL DECIMALS ±.0005 [.013] 3 PL DECIMALS ±.006 [.15] 2 PL DECIMALS ±.01 [.25]	DRAFTER	DATE	STRATEDGE	4393 Viewridge Avenue San Diego, CA 92123		
	PROJECT ENGINEER	DATE		10 LEAD PACKAGE OUTLINE/CATALOG DRAWING		
	CHECKER	DATE				
	MARKETING	DATE				
			SIZE B CAGE CODE OHZT6 DRAWING NO C580447 REV -			
			SCALE NONE	C580447_1	SHEET 1 OF 2	

PROPRIETARY
 THE INFORMATION CONTAINED IN OR DISCLOSED BY THIS DOCUMENT IS CONSIDERED
 PROPRIETARY BY STRATEDGE CORPORATION. THE ITEMS AND INFORMATION CONTAINED
 OR DISCLOSED HEREIN SHALL NOT BE USED, COPIED OR REPRODUCED IN WHOLE OR IN
 PART, NOR SHALL THE CONTENTS BE REVEALED IN ANY MANNER TO ANY PERSON
 UNLESS WRITTEN PERMISSION IS FIRST OBTAINED FROM STRATEDGE CORPORATION.

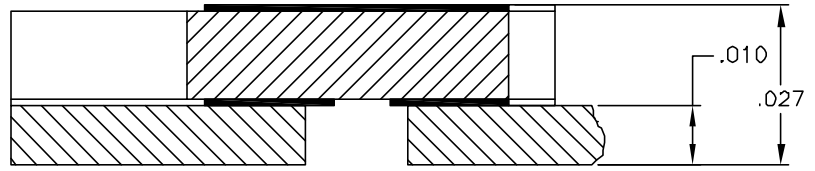
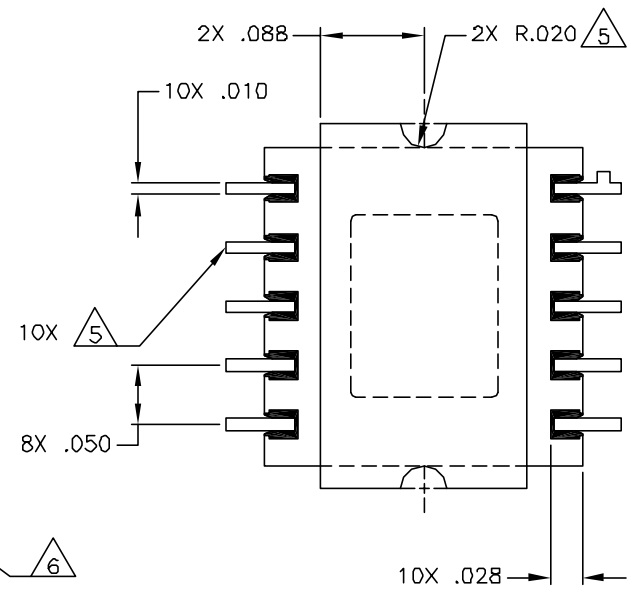
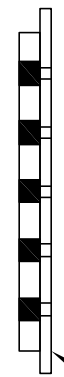
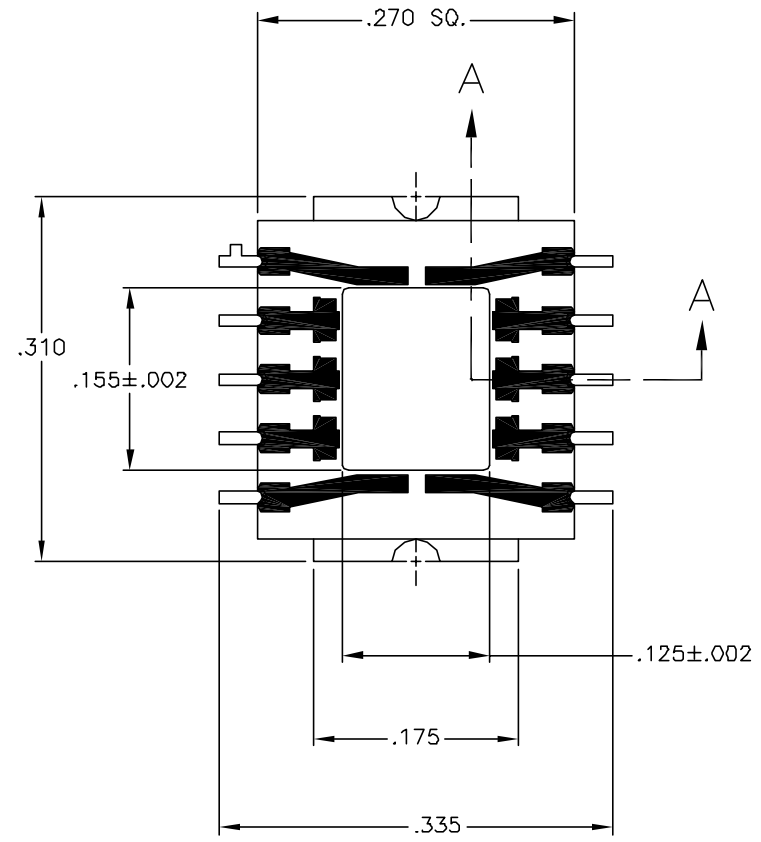

SECTION: A-A

	SIZE	CAGE CODE	DRAWING NO	REV
	B	OHZT6	C580447	-
SCALE	NONE	C580447_2	SHEET 2 OF 2	